

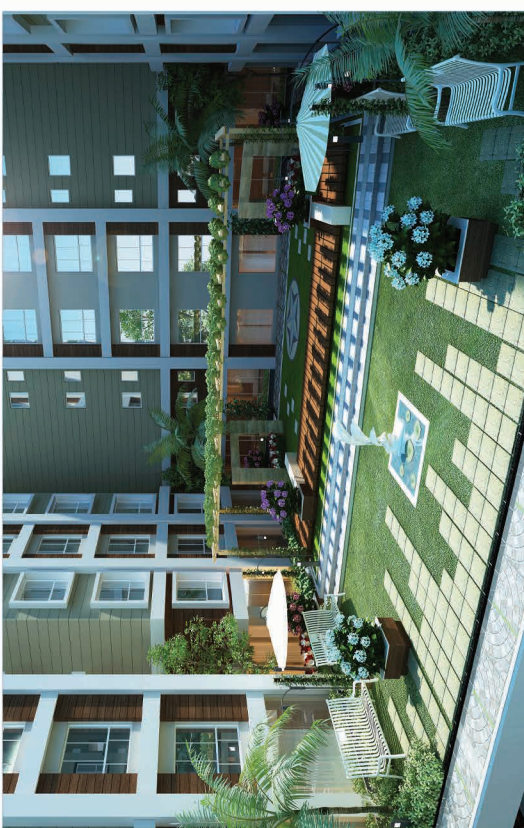

# Stay at freshiest location

- Lincoln's High School - 2km
- Doon Heritage - 1 km
- Tenzing Norgay Bus Terminus - 2.5 km
- Medica North Bengal Hospital - 2.5 km
- North Bengal Neuro Centre - 2.5 km
- Bagdogra Airport - 15 km
- New Jalpaiguri Railway Station - 7 km
- City Centre Mall - 4 km
- Neotia Getwell Hospital - 4 km
- Local Market - 1km



Developer :



Sita Mansion, 2.5 Mile, Sevoke Road, Siliguri-734001. Website : [www.sbmgroupindia.com](http://www.sbmgroupindia.com). Email : [info@sbmgroupindia.com](mailto:info@sbmgroupindia.com); [sbmslg@gmail.com](mailto:sbmslg@gmail.com)

Site :

Birsa Munda Bridge, Champasari Main Road , Near Himcourse, Siliguri

Architect :

Raj Agarwal & Associates, Kolkata

Legal :

R. K. Agarwal & Associates, Siliguri

Marketing Agent :



Sanat Trade Centre, 1st Floor, Sevoke Road. Siliguri - 734 001, West Bengal, India. +91 97330 72222 (M), 91 97330 71111 (M)

Website: [www.siliguriproperties.com](http://www.siliguriproperties.com), Email: [siliguriproperties@gmail.com](mailto:siliguriproperties@gmail.com)

Finance Available at attractive interest rates from all leading Banks and Financial Institutions

Disclaimer

This is not a legal document, the plans and photographs are conceptual. The actual product shall vary according to the sole discretion of the developer. No claims shall be entertained by the developer depending on this material.

Design: Be-the-Bee 98311 55329

# Start life fresh

Every ounce of fresh life will seep into your body and mind at SBM Freshia, nature-homes from the SBM Group. As soon as you step in, a whiff of fresh inimitable energy will greet you. Every step that you take will bring your soul closer to the heart of nature. While the greens, blues and million other natural shades soothe your eyes, the whole feeling of being close to earthy life, will refresh your mind and body.

Start life afresh at SBM Freshia

a cluster of 148 lifestyle  
apartments spread over  
80 Cottah approx.

## A fresh helping of greens

A beautiful Landscaped Garden and a generous bouquet of trees will greet you at SBM Freshia. With around 60% of Greenery in the project area, everyday will become a brand new day to you. The fresh breeze will play with your child at the children's playing area. Then you may take your afternoon break with your favourite book under the shade of big trees in the park. Go back to your childhood. Renew your life. Let the company of the spreading greens; transform your being as a whole.

## F5 the club.

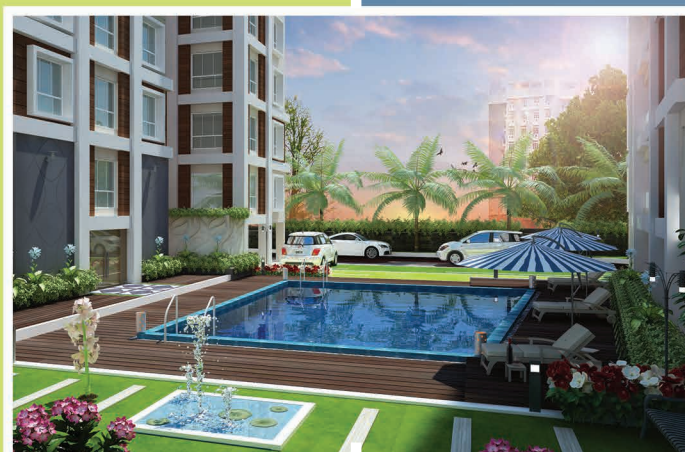

- Multi Gym
- Pool table
- Table tennis
- Carrom Boards
- Card Playing Area
- Swimming pool
- AC Community hall
- Yoga Meditation Area
- Badminton court



## A fresh cluster of new ~ age amenities

- 24 x 7 Security
- Sewage Treatment Plant
- Power Backup\*
- CCTV
- Hi Speed lift
- Fire Fighting
- Intercom

## Specifications

Structure: Earthquake resistant RCC Frames Structures.  
Walls: Brick for internal and external walls.  
Elevation: Elegant looks with finished exterior paint/textured paints.  
External Wall finish: Combination of High Quality paint with textured paint.  
Internal Wall: Smooth finish with white putty of reputed brand.

### Doors/Windows:

Wooden door frame.  
32 mm thick flush door.  
Door fitted with branded hardware.  
Tower bolt in each door.  
34-series anodized aluminum sliding/fixed window fitted with high performance clear glass.

### Floorings:

Lobby: Selected quality Marble/Granite/Tiles with elegant design.  
Bedroom: Selected vitrified tiles of reputed brand.  
Hall: Selected vitrified tiles of reputed brand.  
Toilet/Kitchen: Selected anti skid ceramic tiles/Marble.

### Kitchen:

Counter: Selected granite top with SS. sink of good quality.  
Wall: selected ceramic Tiles of reputed brand up to 2ft above the counter.  
Furnish: Modular kitchen fitted with chimney (optional at extra cost).

### Toilets:

Sanitary ware: Elegant white vitrified sanitary ware of reputed brand.  
C.P. fittings: Luxury Quality of Jaguar or equivalent brand.  
Wall Furnish: Selected ceramic tiles of reputed brand up to door height.

### Electricals:

AC Power Point: In Master Bedroom  
Cables: Fire resistant copper electrical conductors / cables.  
Switches: Elegant modular switches of reputed brand.  
Switchgears: MCB and ELCB and ACCL of reputed brand.

\*at extra cost



- Multi Gym
- Pool table
- Table tennis
- Carrom Boards
- Card Playing Area
- Swimming pool
- AC Community hall
- Yoga Meditation Area
- Badminton court

**Start** Life fresh

Every ounce of fresh life will seep into your body and mind at SBM Freshia, nature-homes from the SBM Group. As soon as you step in, a whiff of fresh inimitable energy will greet you. Every step that you take will bring your soul closer to the heart of nature. While the greens, blues and million other natural shades soothe your eyes, the whole feeling of being close to earthy life, will refresh your mind and body. Start life fresh at SBM Freshia

a cluster of 148 lifestyle apartments spread over 80 Cottah approx.

**F5 the club.**

**A fresh helping of greens**

A beautiful Landscaped Garden and a generous bouquet of trees will greet you at SBM Freshia. With around 60% of Greenery in the project area, everyday will become a brand new day to you. The fresh breeze will play with your child at the children's playing area. Then you may take your afternoon break with your favourite book under the shade of big trees in the park. Go back to your childhood. Renew your life. Let the company of the spreading greens; transform your being as a whole.



- 24 x 7 Security
- Sewage Treatment Plant
- Power Backup\*
- CCTV
- Hi Speed lift
- Fire Fighting
- Intercom

**fresh cluster of new ~ age amenities**

**Structure:** Earthquake resistant RCC Frames Structures.

**Walls:** Brick for internal and external walls.

**Elevation:** Elegant looks with finished exterior paint/ textured paints.

**External Wall finish:** Combination of High Quality textured paint with textured paint.

**Internal Wall:** Smooth finish with white putty of reputed brand.

**Doors/Windows:** Wooden door frame. 52 mm thick flush door. Door fitted with branded hardware. Tower bolt in each door. 34-series anodized aluminum sliding/ fixed window fitted with high performance clear glass.

**Floorings:** Lobby: Selected quality Marble/ Granite/ Tiles with elegant design. Bedroom: Selected vitrified tiles of reputed brand. Hall: Selected vitrified tiles of reputed brand. Toilet/ Kitchen: Selected anti skid ceramic tiles/ Marble.

**Kitchen:** Counter: Selected granite top with SS sink of good quality. Wall: Selected ceramic Tiles of reputed brand up to 2ft above the counter. Furnish: Modular kitchen fitted with chimney (optional at extra cost). Sanitary ware: Elegant white vitrified sanitary ware of reputed brand.

**CT fittings:** Luxury Quality of Jagan or equivalent brand door height.

**Electricals:** AC Power Point: In Master Bedroom. Cables: Fire resistant copper electrical conductors / cables. Switches: Elegant modular switches of reputed brand. Switchgears: MCB and ELCB and ACCL of reputed brand.



**Specifications**



**Freshia** Afresh, anytime

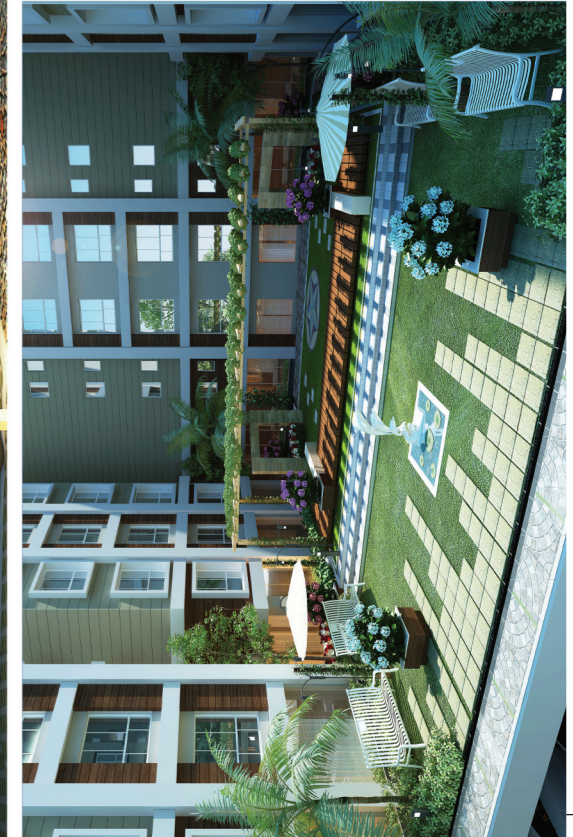

**Stay at freshest location**

- Lincoln's High School - 2km
- Doon Heritage - 1 km
- Tenzing Norgay Bus Terminus - 2.5 km
- Medica North Bengal Hospital - 2.5 km
- North Bengal Neuro Centre - 2.5 km
- Bagdogra Airport - 15 km
- New Jalpaiguri Railway Station - 7 km
- City Centre Mall - 4 km
- Neotia Getwell Hospital - 4 km
- Local Market - 1km

**Developer:** SBM GROUP

Sita Mansion, 25 Mile, Sevoke Road, Siliguri - 734001. Website: www.sbmgroupindia.com. Email: info@sbmgroupindia.com; sbmslg@gmail.com

**Site:** Birsa Munda Bridge, Champasari Main Road, Near Himcoarse, Siliguri

**Architect:** Raj Agarwal & Associates, Kolkata

**Legal:** R.K. Agarwal & Associates, Siliguri

**Marketing Agent:** GFS Realtors

Sanat Trade Centre, 1st Floor, Sevoke Road, Siliguri - 734 001, West Bengal, India. +91 973530 72222 (M), 91 973530 71111 (M)

Website: www.siliguriproperties.com, Email: siliguriproperties@gmail.com

Finance Available at attractive interest rates from all leading Banks and Financial Institutions

**Disclaimer**  
This is not a legal document, the plans and photographs are conceptual. The actual product shall vary according to the sole discretion of the developer. No claims shall be entertained by the developer depending on this material.

Design: Beehive Bee 98311 55329

